

Recognized as the world leader in lactose processing technology, **RELCO's L-TECH™ Lactose Drying System** is designed specifically to process lactose to a high-quality edible powder at the lowest capital and operating costs in the industry. Each process step is engineered to maximize yield efficiencies.

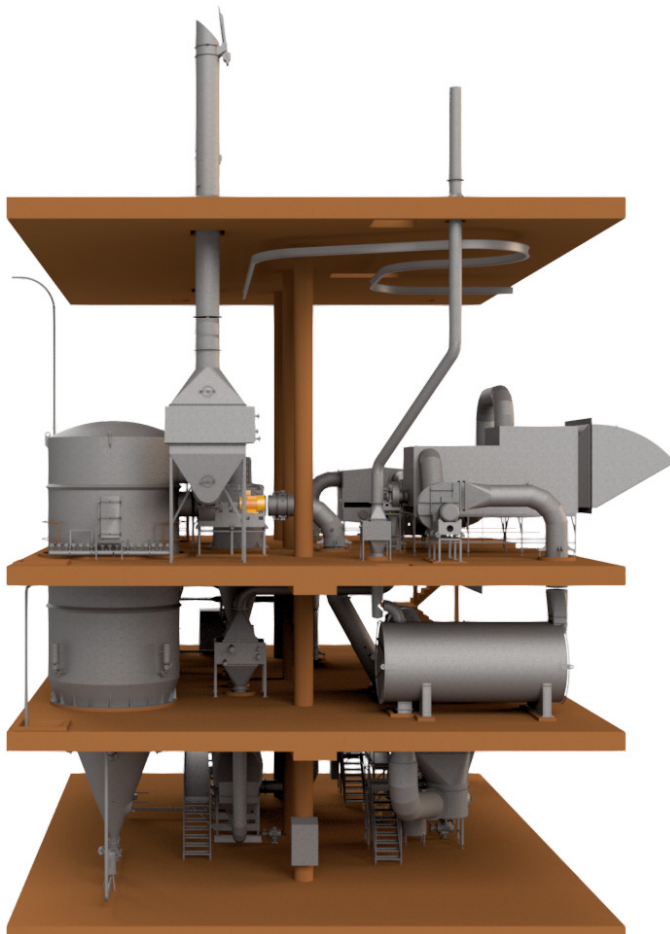

RELCO has the technical and practical experience required to manage the flow of whey from cheese making through separation, ultrafiltration, evaporation, crystallization, refining, drying and packaging. This experience is built into the process design, equipment, and automation. The result is a process where each step works together to produce high-quality lactose with consistently high yields.



FEATURES & BENEFITS

- Designed for processing high-quality lactose products.
- A small footprint with a compact design.
- Meets all USDA, FDA, 3-A, MAF and EHEDG sanitary/hygienic standards.
- Low utility costs for low operating costs.
- Operating & capital costs are minimized as each component is designed for maximum performance.
- The refining & drying processes produce high-quality, edible lactose for many food and pharmaceutical applications.
- RELCO's control system provides precise equipment operation for each step of the process, minimizing operator duties.

ADVANCED PARTS

- **Crystallizer**
Sized for customer requirements; CIP capable; easy to operate; automated for efficient maximum crystal development
- **Refiner**
Fully automated for easy operation; counter-current washing; CIP capable; low-volume water usage; efficient purification process
- **Attrition Dryer**
Small compact size; low air velocity and high air temperature; attrition action breaks up the agglomerates into uniform particle size; product inlet is gravity fed from the basket centrifuge; product moves in a heated air stream from the dryer to an interstage cyclone for reduced dust loading on the bag house
- **Fluid Bed Dryer**
Efficient final stage drying and cooling; CIP capable; replaceable screen
- **Baghouse Collectors**
Hot and cold baghouses collect fine particles from the attrition and fluid bed dryers; fines removed from bag filters are reintroduced to maximize yield; safety explosion venting; sanitary design; easy top-loading bag